

## Disc brake

## Technical data and dimensions

### Gear coupling disc association

Gear coupling type **SDF**

Solid discs (**P**) and ventilated discs (**V**)  
 thickness 30mm

Disc mounting and dismantling without  
 moving the machines back.

Material and balancing of the discs : see  
 the discs "technical data" leaflet quoted in  
 the bottom of the page.

Hub and coupling : oiling protection.

In standard, only the disc is balanced.  
 The assembly is balanced on demand,  
 (parts angularly matched).

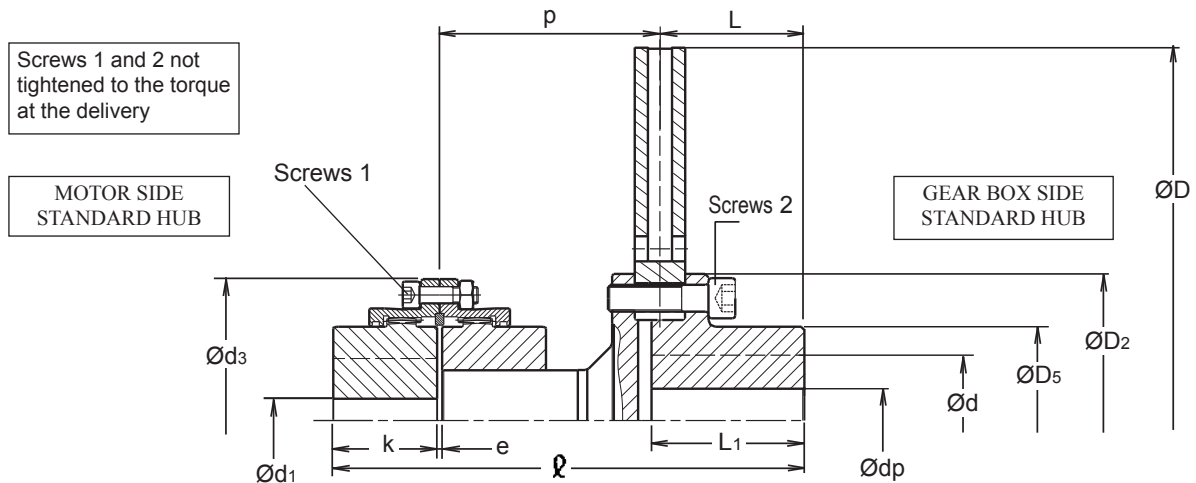

Degrease faces in contact between disc, hub and coupling

Designation			Disc	315 P30/V30	355 P30/V30	395 P30/V30					
			SDF	68		68		68		80	
Assembly	J	P30 V30	kg.m <sup>2</sup>	0,246	0,16	0,391	0,255	0,604	0,368	0,622	0,386
	Weight	P30 V30	kg	32	25	39	30	47,5	36,5	53	42
	$\rho$		mm	274		274		274		286	
	Maximum speed		rpm	3000		2700		2400			
	Maximum braking torque		N.m	Tb ≤ Tp (Tb = maximum braking torque, Tp = maximum peak torque)							
For use with calipers			Check that D – D2 > width of the caliper braking surface (ex.: 4CA and 3CA not associated to discs D < 445) Check that the caliper nominal braking torque is ≤ Tp								
Disc	D		mm	315		355		395			
	D2		mm	124		145		165			
	D5		mm	82		100		112			
	L		mm	102		102		102			
	L1		mm	107		107		107			
	dp		mm	--		--		--			
	d maximum keyed		mm	55		70		75			
	d max. shrink fit		mm	50		60		70			
	Tightening torque screw 2 *		N.m	49		86		135			
Coupling	d3		mm	140		140		140		169	
	e		mm	3		3		3		3	
	k		mm	50		50		50		62	
	p		mm	120,5		120,5		120,5		120,5	
	d1 maximum keyed		mm	68		68		68		80	
	d1 max. shrink fit		mm	63		63		63		75	
	Tightening torque screws 1 *		N.m	33		33		33		60	
	Maximum peak torque (Tp)		N.m	1500		2200		2200			
	Transmissible torque (Tt)		N.m	750		1100		1100			
In every case : Ts < Tp (Ts : motor starting torque)											

\*: greased under head and on thread

Due to continuous development and improvement, all dimensions and characteristics are subject to change without notice

Installation and maintenance  
 Technical data SDF-ML  
 Technical data SMLDF  
 Technical data discs

Leaflets No. M10004-01  
 No. T10004-02  
 No. T10004-03  
 No. T08020-01

03/02/10

1/4

**T10004-01-C**

## Disc brake

## Technical data and dimensions

### Gear coupling disc association

Gear coupling type **SDF**  
 Solid discs (**P**) and ventilated discs (**V**)  
 thickness 30mm  
 Disc mounting and dismantling without  
 moving the machines back.

Material and balancing of the discs : see  
 the discs "technical data" leaflet quoted in  
 the bottom of the page.

Hub and coupling : oiling protection.  
 In standard, only the disc is balanced.  
 The assembly is balanced on demand,  
 (parts angularly matched).

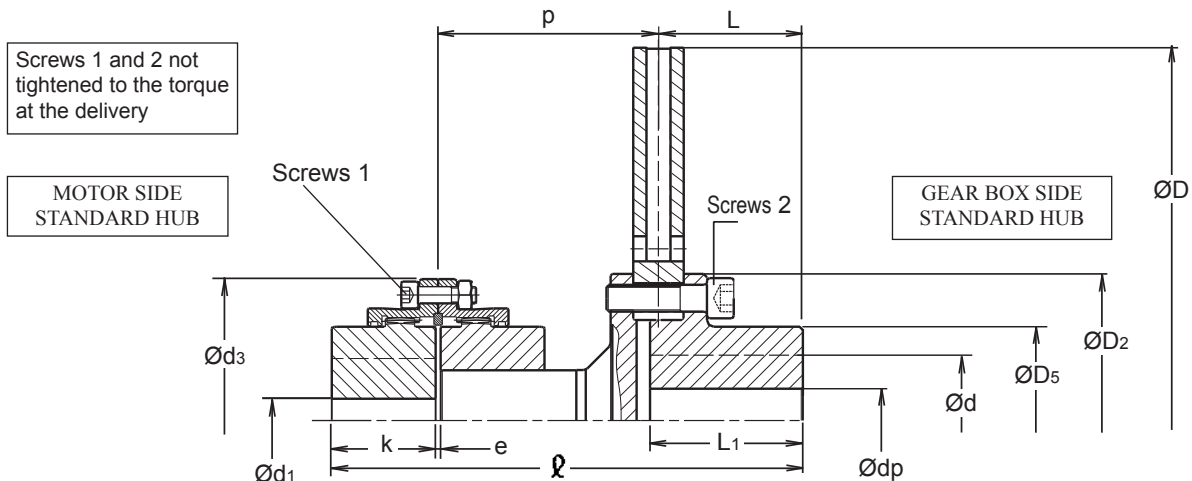

Degrease faces in contact between disc, hub and coupling

Designation		Disc SDF	445 P30/V30						495 P30/V30							
			68		80		100		80		100		115			
Assembly	J	P30	V30	kg.m <sup>2</sup>	0,945	0,586	0,964	0,605	1,012	0,653	1,524	1	1,574	1,05	1,664	1,14
	Weight	P30	V30	kg	58	43	64	49	74	59	86	68	97	79	112	94
	$\varnothing$			mm	307		332		361		347		380		410	
	Maximum speed			rpm	2100						1900					
	Maximum braking torque			N.m	Tb ≤ Tp (Tb = maximum braking torque, Tp = maximum peak torque)											
	For use with calipers				Check that D – D2 > width of the caliper braking surface (ex.: 4CA and 3CA not associated to discs D < 445) Check that the caliper nominal braking torque is ≤ Tpp											
Disc	D			mm	445						495					
	D2			mm	175						218					
	D5			mm	112						155					
	L			mm	135						135					
	L1			mm	140						140					
	dp			mm	--						30					
	d maximum keyed			mm	80						110					
	d max. shrink fit			mm	70						100					
	Tightening torque screw 2 *			N.m	210						290					
Coupling	d3			mm	140	169	200	169	200	228						
	e			mm	3	3	5	3	5	5						
	k			mm	50	62	76	62	76	90						
	p			mm	120,5	133,5	147,5	148,5	166,5	182,5						
	d1 maximum keyed			mm	68	80	100	80	100	115						
	d1 max. shrink fit			mm	63	75	92	75	92	106						
		Tightening torque screws 1 *		N.m	33	60	60	60	60	95						
		Maximum peak torque (Tp)		N.m	2200	3800	6000	3800	6000	9400						
		Transmissible torque (Tt)		N.m	1100	1900	3000	1900	3000	4700						
						In every case : Ts < Tp (Ts : motor starting torque)										

\*: greased under head and on thread

Due to continuous development and improvement, all dimensions and characteristics are subject to change without notice

Installation and maintenance  
 Technical data SDF-ML  
 Technical data SMLDF  
 Technical data discs

Leaflets No. M10004-01  
 No. T10004-02  
 No. T10004-03  
 No. T08020-01

03/02/10

2/4

**T10004-01-C**

## Disc brake

## Technical data and dimensions

### Gear coupling disc association

Gear coupling type **SDF**  
 Solid discs (**P**) and ventilated discs (**V**)  
 thickness 30mm  
 Disc mounting and dismantling without  
 moving the machines back.

Material and balancing of the discs : see  
 the discs "technical data" leaflet quoted in  
 the bottom of the page.

Hub and coupling : oiling protection.  
 In standard, only the disc is balanced.  
 The assembly is balanced on demand,  
 (parts angularly matched).

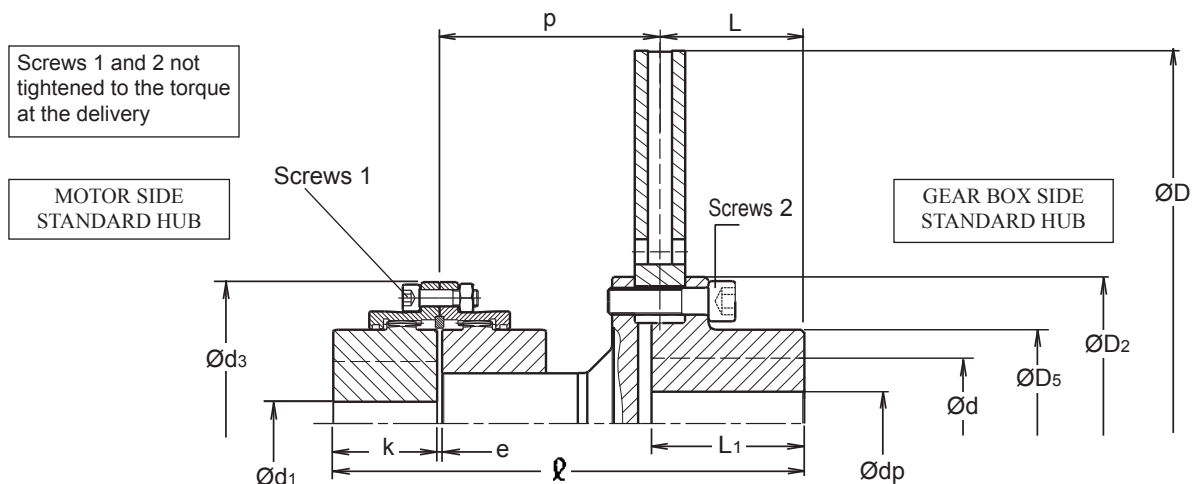

Degrease faces in contact between disc, hub and coupling

Designation		Disc SDF	550 P30/V30						625 P30/V30									
			80		100		115		100		115		135		150			
Assembly	J	P30	V30	kg.m <sup>2</sup>	2,247	1,307	2,297	1,357	2,387	1,447	3,775	2,329	3,863	2,417	4,065	2,619	4,352	2,906
	Weight	P30	V30	kg	97	74	108	85	123	100	131	104	145	118	167	140	195	168
	$\varrho$			mm	347		380		410		380		410		441		483	
	Maximum speed			rpm	1800						1500							
	Maximum braking torque			N.m	T <sub>b</sub> ≤ T <sub>p</sub> (T <sub>b</sub> = maximum braking torque, T <sub>p</sub> = maximum peak torque)													
For use with calipers		Check that D – D <sub>2</sub> > width of the caliper braking surface (ex.: 4CA and 3CA not associated to discs D < 445) Check that the caliper nominal braking torque is ≤ T <sub>p</sub>																
Disc	D			mm	550						625							
	D <sub>2</sub>			mm	218						238							
	D <sub>5</sub>			mm	155						168							
	L			mm	135						135							
	L <sub>1</sub>			mm	140						140							
	d <sub>p</sub>			mm	30						30							
	d maximum keyed			mm	110						120							
	d max. shrink fit			mm	100						105							
Tightening torque screw 2 *			N.m	290						410								
Coupling	d <sub>3</sub>			mm	169	200	228		200	228	266		298					
	e			mm	3	5	5		5	5	6		6					
	k			mm	62	76	90		76	90	105		120					
	p			mm	148,5	166,5	182,5		166,5	182,5	198		225					
	d <sub>1</sub> maximum keyed			mm	80	100	115		100	115	135		150					
	d <sub>1</sub> max. shrink fit			mm	75	92	106		92	106	125		140					
	Tightening torque screws 1 *			N.m	60	60	95		60	95	171		235					
	Maximum peak torque (T <sub>p</sub> )			N.m	3800	6000	9400		6000	9400	13800		20700					
	Transmissible torque (T <sub>t</sub> )			N.m	1900	3000	4700		3000	4700	6900		10350					
	In every case : T <sub>s</sub> < T <sub>p</sub> (T <sub>s</sub> : motor starting torque)																	

\*: greased under head and on thread

Due to continuous development and improvement, all dimensions and characteristics are subject to change without notice

Installation and maintenance	Leaflets No. M10004-01	03/02/10	3/4
Technical data SDF-ML	No. T10004-02		
Technical data SMLDF	No. T10004-03		
Technical data discs	No. T08020-01		
<b>T10004-01-C</b>			

## Disc brake

## Technical data and dimensions

### Gear coupling disc association

Gear coupling type **SDF**  
 Solid discs (**P**) and ventilated discs (**V**)  
 thickness 30mm  
 Disc mounting and dismantling without  
 moving the machines back.

Material and balancing of the discs : see  
 the discs "technical data" leaflet quoted in  
 the bottom of the page.

Hub and coupling : oiling protection.  
 In standard, only the disc is balanced.  
 The assembly is balanced on demand,  
 (parts angularly matched).

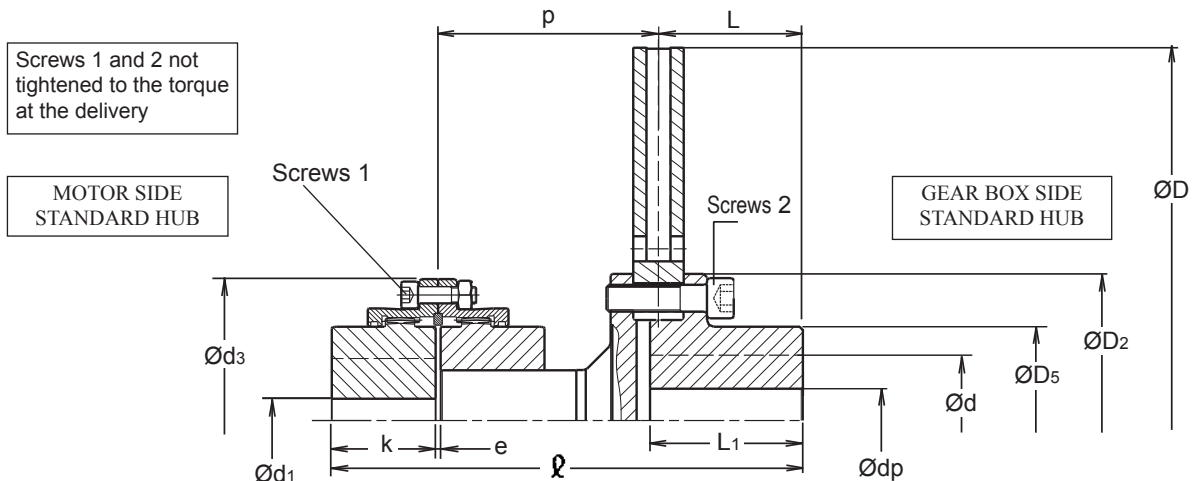

Degrease faces in contact between disc, hub and coupling

Designation		Disc SDF	705 P30/V30				795 P30/V30											
			115		135		150		170		135		150		170			
Assembly	J	P30	V30	kg.m <sup>2</sup>	6,165	3,935	6,37	4,14	6,655	4,425	7,153	4,923	10,092	6,512	10,378	6,798	10,872	7,292
	Weight	P30	V30	kg	173	140	196	163	223	190	259	226	233	193	260	220	295	255
	$\varnothing$	mm			410		441		483		513		441		483		513	
	Maximum speed	rpm			1300				1200									
	Maximum braking torque	N.m			Tb ≤ Tp (Tb = maximum braking torque, Tp = maximum peak torque)													
For use with calipers		Check that D – D2 > width of the caliper braking surface (ex.: 4CA and 3CA not associated to discs D < 445) Check that the caliper nominal braking torque is ≤ Tp																
Disc	D	mm			705				795									
	D2	mm			268				300									
	D5	mm			190				216									
	L	mm			135				135									
	L1	mm			140				140									
	dp	mm			30				30									
	d maximum keyed	mm			135				150									
	d max. shrink fit	mm			120				135									
Tightening torque screw 2 *	N.m			550				710										
Coupling	d3	mm			228	266	298	330	266	298	330							
	e	mm			5	6	6	8	6	6	8							
	k	mm			90	105	120	135	105	120	135							
	p	mm			182,5	198	225	239	198	225	239							
	d1 maximum keyed	mm			115	135	150	170	135	150	170							
	d1 max. shrink fit	mm			106	125	140	160	125	140	160							
	Tightening torque screws 1 *	N.m			95	171	235	235	171	235	235							
	Maximum peak torque (Tp)	N.m			9400	13800	25300	29200	13800	25300	36700							
	Transmissible torque (Tt)	N.m			4700	6900	12650	14600	6900	12650	18350							
	In every case : Ts < Tp (Ts : motor starting torque)																	

\*: greased under head and on thread

Due to continuous development and improvement, all dimensions and characteristics are subject to change without notice

Installation and maintenance  
 Technical data SDF-ML  
 Technical data SMLDF  
 Technical data discs

Leaflets No. M10004-01  
 No. T10004-02  
 No. T10004-03  
 No. T08020-01

03/02/10

4/4

**T10004-01-C**